

Tower of Septimus Stout (Uriah 34, C.Y. 756)

- | | | | |
|--|---|---|--|
| 1. Portal Chamber | 8. Lupus's Chamber | 15. Chapel of Tasman | 19. Inner Gallery (works depicting Illnazzzer and his disciples) |
| 2. Foyer | 9. Shana's Chamber | 16. "Moons" shrines: Aeshandra, DeLoco, Fabian, Skoth, Vvarrda, Xar'al. | 20. Library |
| 3. Bathing Chamber | 10. Mirod's Chamber | 17. Foyer with fresco of Illnazzzer | 21. Foyer |
| 4. Privy | 11. Charis's Chamber | 18. Outer Gallery (includes painting of Dorak) | 22. Kitchen |
| 5. Barracks/Servant's quarters | 12. Pinch's Chamber | | 23. Observatory |
| 6. Smithy/Workshop | 13. Shrine to Rhondelain | | 24. Banquet Hall |
| 7. Foyer with statue of Jordan Stormfather | 14. "Sun" shrines: Caidian, Delaeni, Lorelli, Ponteous, Uriah, Wysshah. | | |

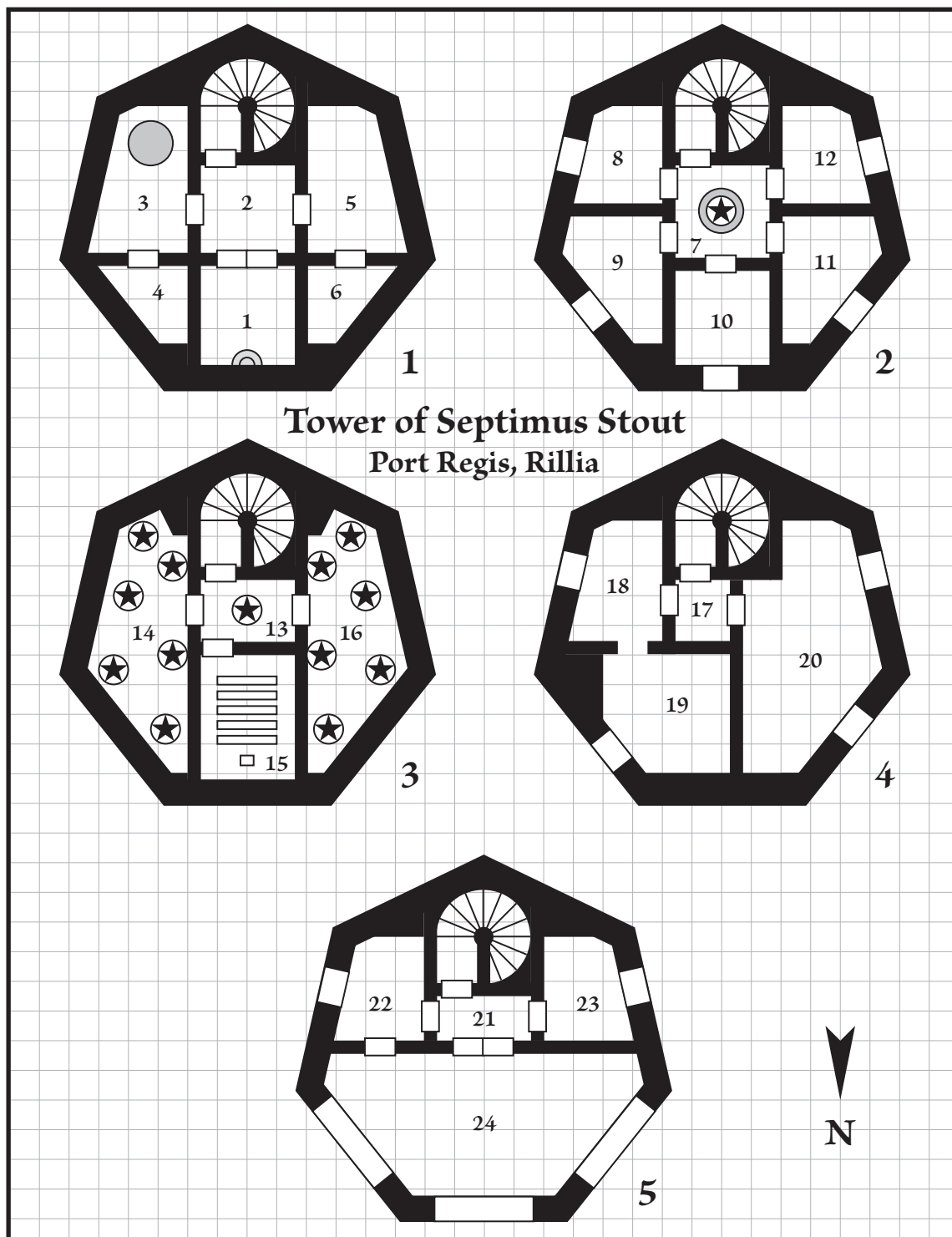

Lupus Dunne's Maps (Uriah 35, C.Y. 756)

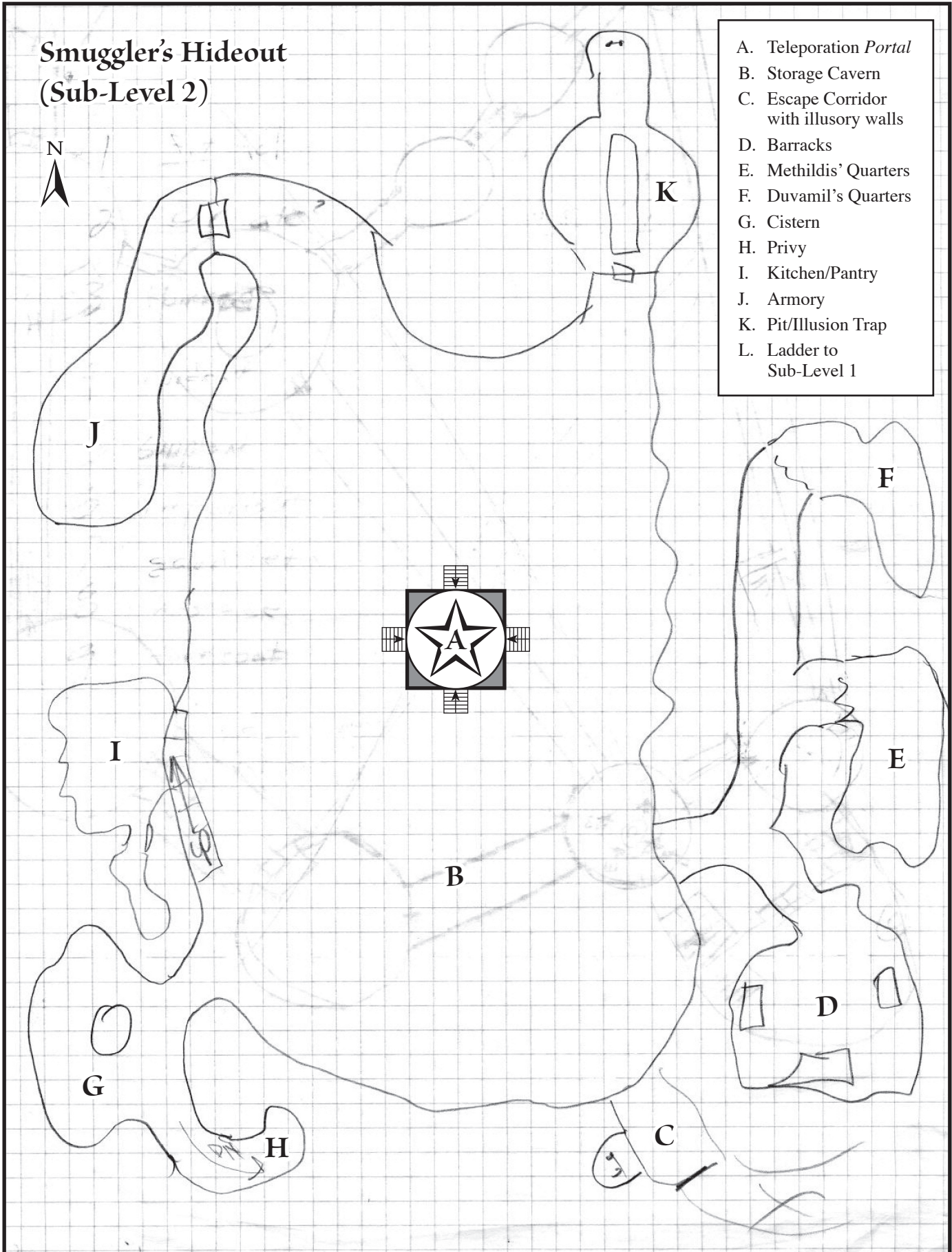

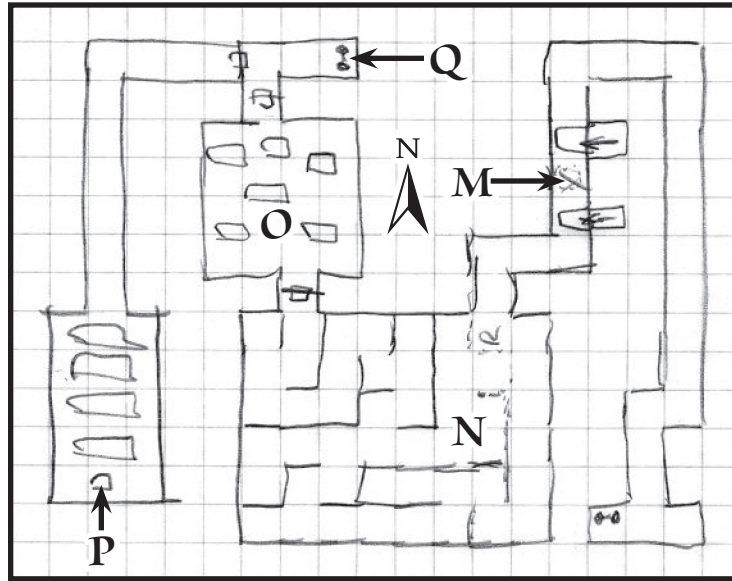

Smuggler's Hideout
(Sub-Level 1)

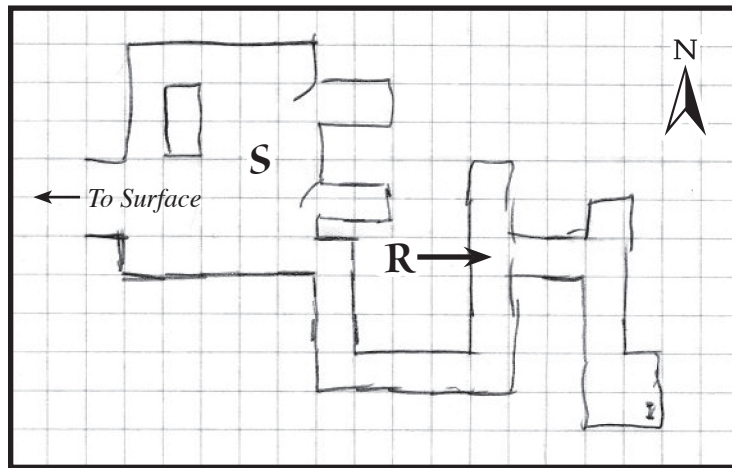

Smuggler's Hideout
(Surface Level)

- M. Sliding Wall Trap
- N. Invisible Labyrinth
- O. Invisible Stones
- P. Chapel of Tasman
- Q. Ladder to Surface Level
- R. Summoning Trap (Combat with Celestial Lions)
- S. Stables (horses and wagon found here)